



HUGH CONWAY MORRIS

Director, Manifest Design Workshop Ltd

Architect • Oak Framer • Lime Burner • Earth Builder

BA (Hons) MArch RIBA AABC SPAB Lethaby Scholar

Hugh is a principal architect, craftsman and director of Manifest, and has run the practice since founding it in 2009. Hugh studied architecture at the University of Sheffield. Following graduation with First Class honours BA, he worked as both designer and carpenter for the Kós Károly Association in Hungary and Transylvania (Romania), also working as project manager for the Opre Roma Community building group in Debrecen, eastern Hungary.

Having returned to England, Hugh developed his expertise in the conservation of historic buildings, already inspired by the living traditions of Romania and Hungary. Working first in Bath, then on the prestigious Lethaby Scholarship sponsored by the Society for the Protection of Ancient Buildings (SPAB), he took up positions in Oxfordshire and Berkshire for conservation specialists Nick Cox and Peter McCurdy, again as both carpenter and architect.

Hugh is now a very active member of the SPAB, sitting on and reporting to committees and carrying out casework, as well as acting as visiting specialist in timber conservation and lime burning at the Society's annual working parties. He is registered with the Architects Accredited in Building Conservation (AABC). Hugh also sits on the Fabric Advisory Committee for the University Church of St Mary the Virgin, Oxford, and is a member of the PCC of his home church at Huntley in western Gloucestershire.

Hugh's love of material, and timber especially, has also led to his membership of the Carpenters' Fellowship, the traditional framers' association. Hugh's position at Manifest enables him to pursue his passion for the revelation of the built form through context - community, natural and spiritual - to engage through real materials with real people in the world, and to bring into being beautiful, meaningful and sustainable buildings.

Career History

2014 – Manifest Design Workshop (Director)

2012 – McCurdy & Co. Oak Framers (Carpenter)

2010 – Nick Cox Architects (Project Architect)

2007 – Nash Partnership, Bath

2004 – Esztány Architects, Transylvania

Education

2010 – Examination in Practice & Management (Oxford Brookes University)/RIBA Pt III

2009 – Lethaby Scholarship (Society for the Protection of Ancient Buildings)

2004 – Diploma/MArch in Architecture (Sheffield University)/RIBA Pt II

2001 – BA (Hons) Architecture (Sheffield University), First/RIBA Pt I

Other Professional Experience

- Caseworker, visiting specialist, and lime-burning tutor for the Society for the Protection of Ancient Buildings
- Member of the Fabric Advisory Committee to the University Church, Oxford

Key Skills

- Practical knowledge of traditional building construction through work “on the tools”, as a professional oak-framer, lime-burner and earth builder.
- Surveys and inspections of a wide range of historic buildings and structures.
- Architectural design and work in historic contexts.

Memberships

- Architects' Registration Board
- Royal Institute of British Architects
- Architects Accredited in Building Conservation (AABC)
- Society for the Protection of Ancient Buildings
- Building Limes Forum
- Carpenters' Fellowship
- Earth Building UK & Ireland

- Sensitive retro-fit of vulnerable heritage buildings.
- Preparation of quinquennial surveys, heritage reports and impact assessments, as well as listed building consent & Faculty applications and contract management.
- Rigorous understanding of technical conservation detailing, including sourcing of appropriate materials.

Special Interests

- The English & Welsh traditions in oak framing.
- Localised lime production and sourcing.
- Earth construction and light-straw-clay.
- The use of traditional materials in assuring a low-carbon future.
- The mathematics of medieval architecture.
- The relation between architecture, sustainability and theology.
- Understanding the British landscape through long-distance walking and freehand drawing.
- Natural living, star-gazing and foraged foods.

Key Projects



St Martin's, Bladon (Oxfordshire)

Client: PCC of St Martin's

Listing: Grade II

Status: complete

Value: N/A

Hugh is appointed inspecting architect to St Martin's, Bladon, and carried out their most recent quinquennial survey in 2024.



Watlington Methodist Church, Watlington (Oxfordshire)

Client: Watlington Methodist Church

Listing: Grade II

Status: complete

Value: £50,000

Survey and specification for repair of Welsh slate roof and roof structure to this significant listed 19th century building.



St Mary of the Angels, Brownhill (Gloucestershire)

Client: Friends of Friendless Churches

Listing: Grade II

Status: complete

Value: TBC

Manifest have worked on several churches cared for by the Friends of Friendless Churches, carrying out and co-ordinating inspections, surveys and repair works.



St Ann's Vestry Hall, City of London

Client: Ancient Monuments Society

Listing: Grade II

Status: complete

Value: £30,000

Vestry Hall, a little gem designed by Sir Banister Fletcher, occupies a tight site in the Square Mile. Manifest were engaged to repair and replace failing drainage and lead roof, together with repairs to a timber staircase.



Assumption of the Blessed Virgin, Hardmead (Buckinghamshire)

Client: Friends of Friendless Churches

Listing: Grade I

Status: complete

Value: TBC

This church has suffered from some years' lack of care, and Manifest were commissioned to carry out a range of condition surveys and investigations to co-ordinate repair works. These included a long-term structural monitoring programme over 18 months, in association with Triskele Conservation.



Roof Repairs – St Peter & St Paul, Yattendon (Berkshire)

Client: St Peter & St Paul, Yattendon

Listing: Grade I

Status: ongoing, Faculty granted

Value: £30,000

Project to solve a long-standing and ongoing problem of leaking roof at vestry chimney abutment.



Roof repairs to manor house (Monmouthshire)

Client: private client

Listing: Grade II*

Status: complete

Value: £200,000

Manifest acted as architects, carrying out condition surveys and drawing up detailed repairs for listed building consent. We then worked on the tools on specialist repairs within the roof structure.



New oak frame to medieval cottage (Oxfordshire)

Client: private client

Listing: Grade II

Status: complete

Value: £80,000

Project to re-build a fire-damaged medieval cottage in the original manner of its green oak frame. Manifest worked under a main contractor providing specialist frame design and carrying out full framing works on the tools.



The Orchard, Chorleywood (Hertfordshire)

Client: private client

Listing: Grade I

Status: complete

Value: £60,000

Conservation works to address structural movement and damp ingress, with works to internal finishes, rainwater goods and roofing to this highly significant Grade I building – the home which Voysey built for himself and his family.



Cob oven building course for Fathom Trust (Brecknockshire)

Client: Fathom Trust

Listing: N/A

Status: complete

Value: N/A

Manifest were commissioned as crafters to support participants in the Fathom Trust's "Making Well" course, teaching cob oven building in the Brecon Beacons.



Douglas-fir-framed gazebo (Cambridgeshire)

Client: private client

Listing: unlisted

Status: complete

Value: £15,000

Manifest designed and built this gazebo in large-section Douglas fir, for outdoor living.



New veranda in Wolvercote (Oxfordshire)

Client: private client

Listing: unlisted

Status: complete

Value: £15,000

Manifest were commissioned to build a new veranda in Douglas fir, with wide spans and lack of bracing challenging the structural performance. Designed by Ecologos (Oxford).



Repairs to historic timber frame, Chalgrove (Oxfordshire)

Client: private client

Listing: Grade II

Status: complete

Value: £20,000

Manifest carried out full condition surveys, applied for listed building consent, and carried out repairs to the historic timber frame, including posts, rails and sole plate.



Oak-framed extension to listed cottage, Clanfield (Oxfordshire)

Client: private client

Listing: Grade II

Status: complete

Value: £100,000

Manifest designed and built this new extension, completed in a traditional oak frame with fully glazed front. All natural materials were specified, including stone walling, sheepswool insulation and lime plasters.



Retro-fit to Victorian House, Oxford (Oxfordshire)

Client: private client

Listing: unlisted, c.1870

Status: complete

Value: £50,000

Manifest carried out careful designs and specifications in natural, breathable materials to complete the retro-fitting of insulation and new details to this classic north Oxford Victorian house, including a new limecrete floor.



Cartshed Conversion Project, Tackley (Oxfordshire)

Client: private client

Listing: Grade II

Status: complete

Value: £300,000

Manifest obtained listed building consent for the conversion of this old cartshed to a new dwelling, with a set of detailed specifications to allow the building's breathable anatomy to continue, and a set of designs carefully laid out to preserve the character and appearance of the barn.



Littlemore Village Hall, Littlemore (Oxfordshire)

Client: Littlemore Village Hall

Listing: unlisted, c.1920

Status: ongoing

Value: £100,000

Manifest are appointed as the inspecting architects to this beautiful Edwardian building in the village of Littlemore. Ongoing projects include retro-fitting of insulation to the historic roof structure, and conversion works to provide an accessible entrance.



The Folly (new house) (Hampshire)

Client: private client

Status: complete

Value: £250,000

Manifest designed a new house for this smallholding in rural Hampshire. Designed for a compact site with limitations on height, the house's exterior belies its spacious interior, with double-height living room open to a glazed rooflight above.



Tudor House, Sutton Courtenay (Oxfordshire)

Client: private client

Listing: Grade II

Status: complete

Value: £300,000

Careful repair work to this 16th century house included timber repairs to the oak and softwood frames, repointing, roof repairs, limewashing and new insulated build-ups to attic rooms, as well as extensive new drainage layouts.



Ham Court, Bampton (Oxfordshire)

Client: private client

Listing: Grade II*

Status: complete

Value: £100,000

New buildings to the curtilage of this significant grade II* listed medieval castle and manor house.



New Barn Farm, Cholsey (Oxfordshire)

Client: Grundon Ltd

Listing: Grade II

Status: complete

Value: TBC

Manifest undertook a full condition survey and conservation management plan for this significant asset, an aisled timber barn in south Oxfordshire.



Westcroft, Cambridge (Cambridgeshire)

Client: private client

Status: complete

Value: £100,000

The property is a listed house in the old village of Chesterton, a timber-framed construction typical of this part of East Anglia. Projects include a new building within the curtilage, an extension (carefully designed to use breathable and natural building technologies to sit alongside the historic structure), and a variety of furniture and other woodwork.



Covered Walkway, Upper Castle Combe (Wiltshire)

Client: private client

Status: complete

Value: £12,000

Manifest constructed this traditional oak-framed structure within the grounds of the listed building.

Relevant projects carried out by Hugh as Carpenter at McCurdy & Co.:



Sam Wanamaker Playhouse, The Globe Theatre, London

The Sam Wanamaker Playhouse is an indoor theatre, based on a Jacobean design, the natural complement to the Globe, in whose complex it is situated. Hugh worked on the tools to frame structural and decorative timbers.



Oak House Museum, Sandwell (Birmingham)

Hugh worked with qualified German *Zimmermann* Tobias Vokuhl on the tools to carry out conservative repair work to this significant timber-framed building, dating to c.1600, in Sandwell in the West Midlands. Work included minor patch repairs to replacements of elements such as sole plates and posts.



Garden Gate

Hugh worked on this as a sole commission within McCurdy & Co., creating both gate and timber-framed arbor.

Relevant projects carried out by Hugh at Nick Cox Architects:



Cottesbrooke Hall (Northamptonshire)

Comprehensive re-roofing of the east quadrant to the Hall, with highly complex shape for new lead roof with lead-lined and stainless steel gutters; additional rooflights formed and all junctions with listed Hall carefully detailed.



St Swithun's Church, Worcester

Careful installation of kitchen into existing north room, and sensitive re-wiring of nave without harming significant Georgian box-pews.

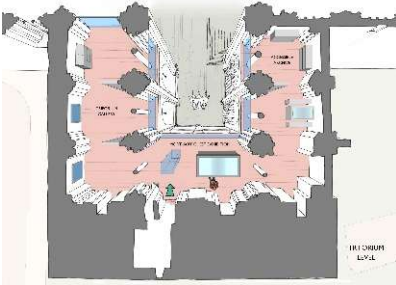

Winchester Cathedral

Various works, including proposals for renewing the lead roof to the presbytery, relocation of the Tournai marble font, and re-ordering of the nave altar and choir stalls to this Grade I listed building.



Windrush Mill

Full renovation of existing listed mill, including comprehensive new services, stone and mortar conservation, re-roofing and overhaul, with associated new structures and bridge over the River Windrush.



Blenheim Palace (Oxfordshire)

Various works, including the several highly-visible stone repair projects to this Grade I listed country house and UNESCO World Heritage Site, on the highly visible south front, together with repair works to the pools of the Water Garden.